

Index Fasteners, Inc.

"Providing Solutions to OEM and Distribution since 1977"

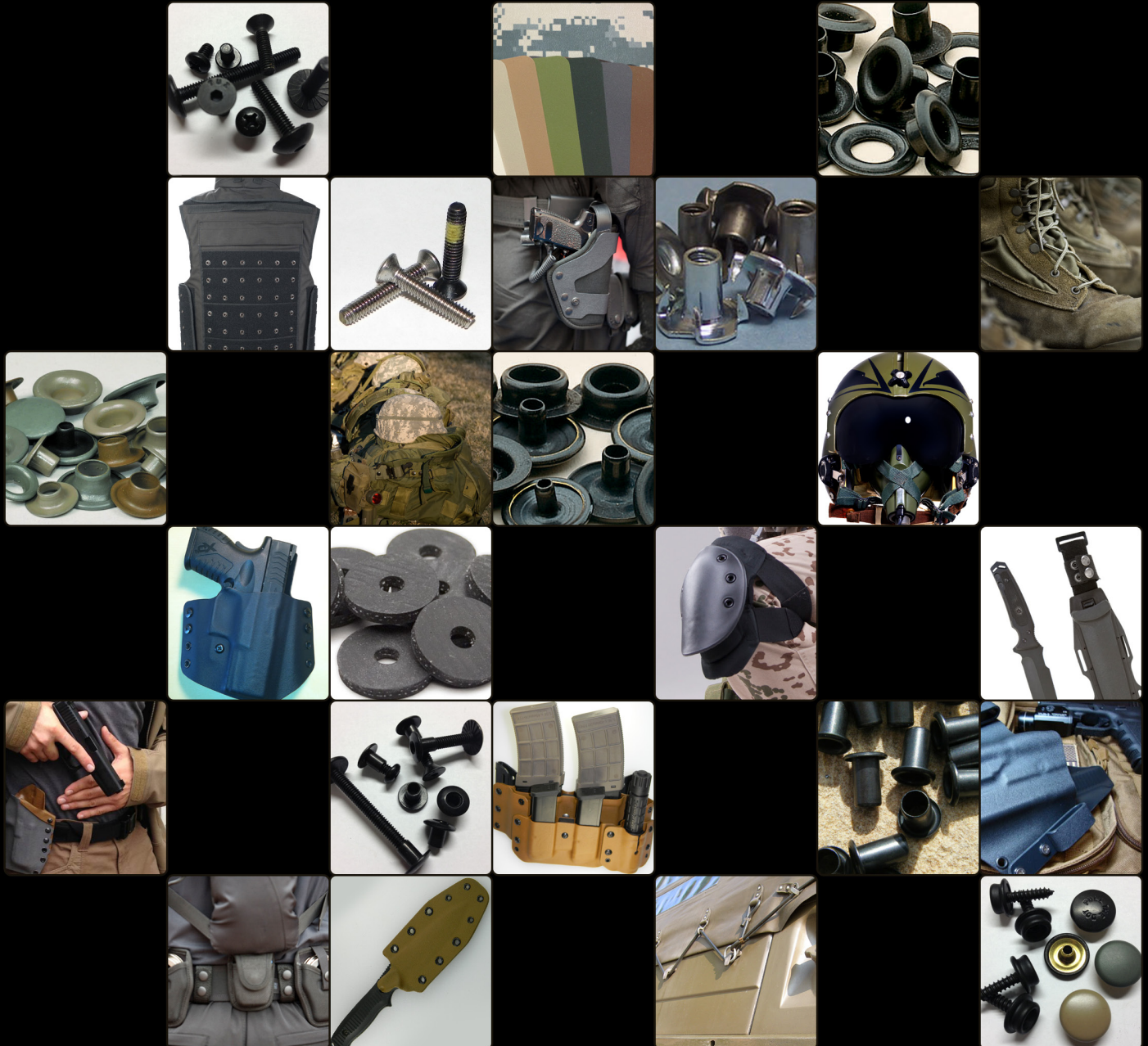

Military, Law Enforcement and Public Defense



Scovill



Palnut®

YKK SNAP FASTENERS AMERICA Inc.



JH Johnson & Hoffman
precision metal stamping

KYDEX
THERMOPLASTIC SHEET



An American flag is shown on the left side of the page, partially visible, with its red and white stripes and blue field with stars. The background of the entire page is a textured, light brown surface.

For three generations

Index Fasteners, Inc. has been a master authorized stocking distributor for high quality products manufactured by leading industry stalwarts. We have a quality reputation which is earned through providing an excellent and dependable service. Index Fasteners, Inc. aims to provide all of its customers with service and products which are to their complete satisfaction.

Index Fasteners, Inc. is ISO 9001:2008 certified distributor and is able to provide Manufacturer Certification on all Military-Spec (MS) and Air-Force/Navy (AN) cross references. We are an ROHS, PFOS and Berry Amendment compliant distributor.

Index Fasteners, Inc. supports some of the world's largest Military, Law Enforcement, Emergency related sub-contractors, and OEM's and is proud to do it with quality U.S. made products, this catalog is dedicated to these industries.

Index
Fasteners, Inc.

KYDEX® is a US manufactured thermoplastic material. It is frequently used as an alternative to leather in the production of firearm holsters, knife sheaths and various other retention related gear. Engineered for thermoforming fabrication the **KYDEX**® sheet combines the advantageous properties of both acrylic and the polyvinyl chloride components. From acrylic, it obtains superior rigidity and formability; from PVC, outstanding toughness, chemical resistance and good interior finish ratings.

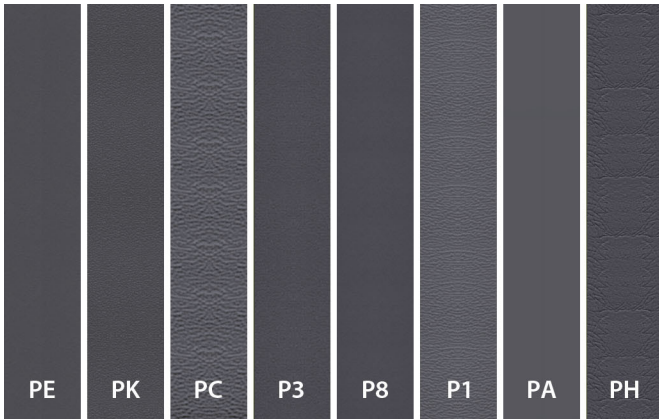

Colors/Patterns

The **KYDEX**® color palette is vast and also customizable. IFI provides a few industry colors that we have deemed as standards for purposes of this industry specific catalog. Some of these colors are below. Patterns such as Military Camouflage or custom logo's are also available in several options. For more standard color options or information on custom colors/patterns please call us.



Black



Coyote Brown



OD or Olive Drab
Green



Dark Grey

Texture

From smooth to rough there are several texture options available in **KYDEX**®. Although IFI can supply these various texture options we stock only the P1-Haircell as a standard which is the most popular **KYDEX**® texture relating to this industry specific catalog. For information on all the texture options available please call us.

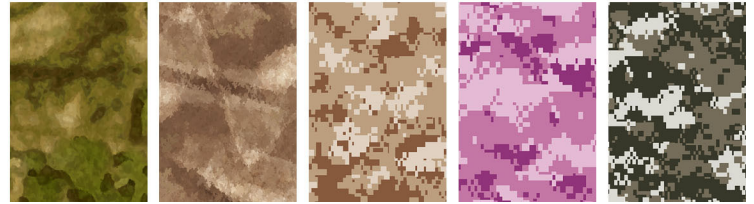

Size Cuts

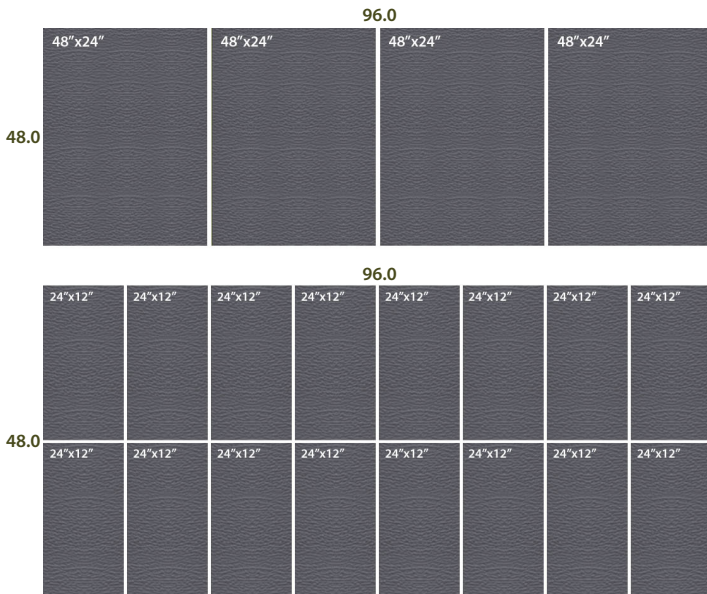

Off the press **KYDEX**® is manufactured in 4'x8' sheets. This size is not always practical for every customer. IFI has narrowed down 2 sheet sizes (cuts) which we have deemed standard stock sizes, along with our full sheet option these sizes are listed below along with a yield chart above. Custom cuts are also available and only require 1 full 4'x8' sheet as a minimum. For more information on size cuts please contact us.

-1'x2'

-2'x4'

-4'x8'

Colors/Patterns

The thickness of **KYDEX**® affects both formability as well as aesthetics. Depending on the customer's project sometimes more than one thickness is required for a single application. For this reason IFI has chosen the four most popular thicknesses to stock as standards and these are listed below. As with the Color and Size options the thickness options from **KYDEX**® range vastly from .028" and up. For more information on your thickness options please contact us.

-.060"

-.093"

-.080"

-.125"

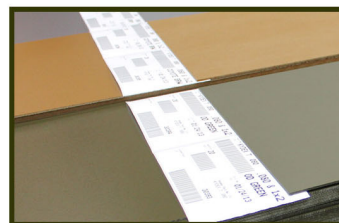
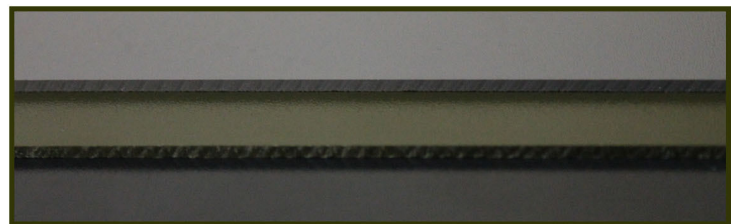

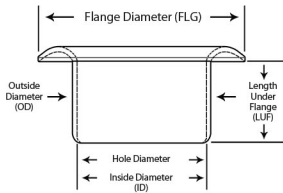

GS® Eyelets

The Stimpson GS® (graduated size) Eyelet group consists of a matrix of 72 eyelets where the length and outside barrel diameters are graduated by 1/32". This grouping will meet the requirements of most general purpose eyeletting applications. GS® Eyelets are most commonly requested in brass, and are normally inventoried in large quantities. GS® Eyelets can also be made from steel, stainless steel, aluminum, and copper.

INCHES MILLIMETERS	2/32 .062 1.58	3/32 .062 2.36	4/32 .062 3.18	5/32 .062 3.96	6/32 .062 4.75	7/32 .062 5.56	8/32 .062 6.35	9/32 .062 7.14	10/32 .062 7.92	11/32 .062 8.74	12/32 .062 9.53	13/32 .062 10.31	14/32 .062 11.10
OUTSIDE DIAMETER	.183 4.65												
FLANGE DIAMETER	.183 4.65												
METAL THICKNESS	.183 4.65	GS 6-3	GS 6-4	GS 6-5	GS 6-6	GS 6-7	GS 6-8	GS 6-9	GS 6-10	GS 6-11	GS 6-12	GS 6-13	GS 6-14
OUTSIDE DIAMETER	.215 5.46												
FLANGE DIAMETER	.340 8.64												
METAL THICKNESS	.011 .279	GS 7-3	GS 7-4	GS 7-5	GS 7-6	GS 7-7	GS 7-8	GS 7-9	GS 7-10	GS 7-11	GS 7-12	GS 7-13	GS 7-14
OUTSIDE DIAMETER	.246 6.25												
FLANGE DIAMETER	.385 9.78												
METAL THICKNESS	.011 .279	GS 8-3	GS 8-4	GS 8-5	GS 8-6	GS 8-7	GS 8-8	GS 8-9	GS 8-10	GS 8-11	GS 8-12	GS 8-13	GS 8-14

Grommet & Washers

All Stimpson metal Grommets and Washers are made in the U.S.A., meet the latest government and commercial specifications, and are supported by a full line of grommet machines.

 <p>Sheet Metal Grommets Metal grommets can be used with plain, teeth, or neck washers.</p>  <p>Plain Washers Basic reinforcement.</p>  <p>Teeth Washers A firmer, tighter grasp.</p>  <p>Neck Washers Reinforces the hole with two entire parts.</p>	 <p>Self-Piercing Grommets & Washers "No Hole Needed" Stimpson Self-Piercing Grommets are made from heavier gauge brass than traditional sheet metal grommets and, when set in a single action without the need for a pre-punched hole.</p>   	 <p>Rolled Rim Grommets with Spur Washers Stimpson Rolled Rim Grommets and Spur Washers interlock, their teeth grasping the material, to provide a rugged, unyielding setting.</p> 
---	---	--

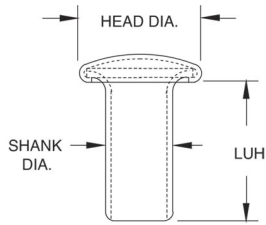

C-E® Rivets

CE® Rivets are made from brass and steel. They can be plated in a nickel, brass, antique bronze or a variety of other finishes. Designed for today's light to medium riveting applications, CE® Rivets are uniform, strong and coil better than conventional tubular rivets. A full line of foot, electric and pneumatic machines support their application.

CE® 100 Series (roll setting)

<p>CE® 100 5/32</p>  <p>Shk Dia Head Dia LUH .120 .224 .156</p>	<p>CE® 100 7/32</p>  <p>Shk Dia Head Dia LUH .120 .224 .218</p>	<p>CE® 100 4/16</p>  <p>Shk Dia Head Dia LUH .120 .224 .250</p>	<p>CE® 100 5/16</p>  <p>Shk Dia Head Dia LUH .123 .224 .312</p>	<p>CE® 100 6/16</p>  <p>Shk Dia Head Dia LUH .123 .224 .375</p>	<p>CE® 100 7/16</p>  <p>Shk Dia Head Dia LUH .123 .224 .437</p>	<p>CE® 100 8/16</p>  <p>Shk Dia Head Dia LUH .123 .224 .500</p>	<p>CE® 100 9/16</p>  <p>Shk Dia Head Dia LUH .123 .224 .562</p>
--	--	--	--	--	--	--	--

CE® 125 Series (roll setting)

<p>CE® 125 3/16</p>  <p>Shk Dia Head Dia LUH .142 .315 .187</p>	<p>CE® 125 4/16</p>  <p>Shk Dia Head Dia LUH .142 .315 .250</p>	<p>CE® 125 5/16</p>  <p>Shk Dia Head Dia LUH .142 .315 .312</p>	<p>CE® 125 6/16</p>  <p>Shk Dia Head Dia LUH .142 .315 .375</p>	<p>CE® 125 7/16</p>  <p>Shk Dia Head Dia LUH .142 .315 .437</p>	<p>CE® 125 8/16</p>  <p>Shk Dia Head Dia LUH .142 .315 .500</p>
---	---	---	---	---	---

Rivet Caps

Available for CE® 100, CE® 125 series, rivet caps add strength and provide a more finished appearance. Caps may be hand fed to the bottom of set tool.

